

65<sup>th</sup> ANNUAL



# OREGONmint GROWERS

**ANNUAL MEETING PROGRAM**  
Research & Industry Update

**JANUARY 9 & 10, 2014**

Salishan Lodge & Golf Resort  
Glenden Beach, Oregon

SPONSORED BY OREGON ESSENTIAL OIL GROWERS LEAGUE



# 65<sup>TH</sup> ANNUAL MINT MEETING PROGRAM

THURSDAY, JANUARY 9, 2014

## TERRACE ROOM

8:00 a.m. Meeting Registration

## LONGHOUSE ROOM A

8:00 a.m. **Exhibitor Displays**  
*Coffee and Tea –  
Courtesy of RCB International, Ltd.  
Muffins and Scones (while they last)  
Courtesy of Cole Industrial*

## LONGHOUSE ROOMS B AND C

8:40 a.m. **Welcome** – *Tim Butler, OEOGL Chairman*

8:45 a.m. **MIRC – Transitioning with a  
Key Retirement in 2014**  
*John Wendel, Chairman  
Mint Industry Research Council  
Albany, Oregon*

9:00 a.m. **MIRC – Chemical Registrations,  
Research and National Industry Issues  
of Interest**  
*Rocky Lundy, Executive Director  
Mint Industry Research Council  
Great Falls, Montana*

9:45 a.m. **Refining the Mint Distillation Process**  
*John Cheatham  
Sierra-Cascade Nursery  
Redmond, Oregon*

10:15 a.m. **Coffee and Exhibits**  
*Coffee and Tea -  
Courtesy of A.M. Todd Company*

11:00 a.m. **The Food Safety Modernization Act –  
Impacts for Growers and Oil Handlers**  
*Stephanie Page  
Oregon Department of Agriculture  
Salem, Oregon*

11:30 a.m. **The State of Oregon Agriculture –  
Never A Dull Moment in a  
Dynamic Industry**  
*Katy Coba, Director  
Oregon Department of Agriculture  
Salem, Oregon*

## CEDAR TREE

12:00 p.m. Lunch

## LONGHOUSE ROOMS B AND C

1:15 p.m. **Mint Biotechnology Update**  
**Part 1: Development of Mint Genome  
Resources at OSU**  
*Kelly Vining  
Oregon State University  
Corvallis, Oregon*

**Part 2: Mint Biotechnology – Advances  
and Challenges in Transgenic Lines**  
*Mark Lange  
Washington State University  
Pullman, Washington*

2:30 p.m. **OEOGL Business Meeting and Election  
of Directors**  
*Tim Butler, OEOGL Chairman, Presiding*

2:45 p.m. **Mint Chemistry 101 – What Oil Buyers  
are Looking for in Your Oil**  
*Doug Walker  
Essex Laboratories  
Napavine, Washington*

3:15 p.m. **Research Round-Up – Where Have We  
Been and Discussion of Priorities**  
*Researcher Panel Presentation*

4:15 p.m. **Exhibit Area Open**

## CEDAR HOUSE

4:15 p.m. **Industry Reception**  
**Hors d'oeuvres and No-Host Bar**  
*Sponsored in part by IP Callison & Sons*



*A special thanks to the  
coffee break sponsors,  
reception sponsor  
and advertisers.*

Visit [oregonmint.org](http://oregonmint.org) for more information.



FRIDAY, JANUARY 10, 2014

## TERRACE ROOM

8:00 a.m. Meeting Registration

## LONGHOUSE ROOM A

8:00 a.m. Exhibit Displays  
 Coffee and Tea –  
 Courtesy of Northwest Farm Credit Services  
 Muffins and Scones (while they last)  
 Courtesy of Labbeemint, Inc.

## LONGHOUSE ROOM B AND C

8:30 a.m. Verticillium Wilt of Mint: Past, Present and Future Research  
 Jeremiah Dung  
 Oregon State University  
 Madras, Oregon

9:00 a.m. Effectively Managing Weeds in Oregon Mint

### Part 1: Willamette Valley and Statewide Programs

Andy Hulting  
 Oregon State University  
 Corvallis, Oregon

### Part 2: Central and Eastern Oregon

Gustavo Sbatella  
 Oregon State University  
 Madras, Oregon

## Part 3: Field Bindweed Management

Jessica Green  
 Oregon State University  
 Corvallis, Oregon

10:00 a.m. Pre- and Post-Harvest Management of Mint Root Borer

### Part 1: Central Oregon Research Update

Marvin Butler  
 Oregon State University  
 Madras, Oregon

### Part 2: Eastern Oregon Research Update

Bryon Quebbeman  
 Quebbeman Crop Management  
 La Grande, Oregon

11:00 a.m. Defending Natural Resource Industries and the 2014 Legislative Session

Paulette Pyle  
 Oregonians for Food and Shelter  
 Salem, Oregon

11:30 a.m. The U.S. Mint Industry – Buyer's Viewpoint

John Wendel  
 RCB International  
 Albany, Oregon

Adjourn

## PREREGISTRATION FORM • Preregistration Deadline is January 3, 2014

Name of Participant(s) \_\_\_\_\_

(one name for each \$28 registration fee paid) \_\_\_\_\_

Address \_\_\_\_\_

City \_\_\_\_\_ State \_\_\_\_\_ Zip \_\_\_\_\_ Phone \_\_\_\_\_

Where would you like the 2015 annual meeting held? (check one)  Coast  Portland  Central Oregon  Southern Oregon

Number	Item	Preregistration	At the Door	Cost
_____	Annual Meeting Registration (Includes one ticket to Industry Reception)	\$28.00 ea.	\$33.00 ea.	\$ _____
_____	Thursday Luncheon	\$14.50 ea.	\$16.00 ea.	\$ _____
_____	*Thursday Industry Reception	\$10.00 ea.*	\$10.00 ea.*	\$ _____*
_____	League Membership (One directory listing for each \$40 membership fee paid)	\$40.00	\$40.00	\$ _____
			TOTAL ENCLOSED	\$ _____

Are you interested in running for the OEOGL Board? Name \_\_\_\_\_ Phone \_\_\_\_\_

\* One ticket to Industry Reception included with each paid registration

# SALISHAN LODGE & GOLF RESORT INFORMATION



## HOTEL RESERVATIONS

Make reservations directly with:  
**Salishan Lodge & Golf Resort**  
Post Office Box 118  
Gleneden Beach, Oregon 97388  
**1-800-452-2300**



## ROOM RATES PER NIGHT:

Standard Guest Room.....\$103 + 10% room tax  
Deluxe Guest Room.....\$123 + 10% room tax  
Premier Guest Room .....\$143 + 10% room tax

Be sure to make hotel reservations by phone by their **December 18** deadline.

***They fill up fast, so don't delay!***

*(When registering by phone, tell the operator you are attending the mint growers convention to get the very special room rates.)*

## PREREGISTRATION DEADLINE IS JANUARY 3, 2014

Preregistration is an easy way to register for the Annual Meeting. It facilitates meal projections, minimizes time required at the registration desk and saves you money over registering at the door. Preregistration packets may be picked up at the League's registration desk the day of the meeting.

**Mail preregistration form with check payable to:**

O.E.O.G.L. - Post Office Box 3366  
Salem, Oregon 97302 • (503) 364-2944

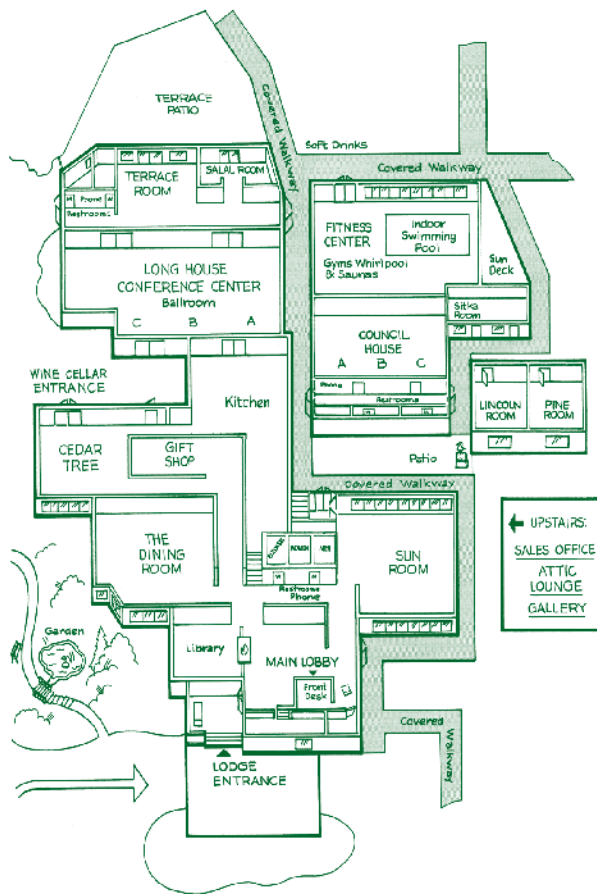

## OREGON ESSENTIAL OIL GROWERS LEAGUE

P. O. Box 3366, Salem, Oregon 97302  
(503) 364-2944 • FAX (503) 581-6819

Visit [oregonmint.org](http://oregonmint.org) for more information.